



Murdoch
UNIVERSITY

University Library Orientation Guide 2019





Welcome to the University Library

Use this Guide to ensure you get the most from the University Library during your time at Murdoch University.

You will find helpful information about our services and facilities that will help you excel in your studies - including library resources you should use in your assignments, our study spaces and how to get personalised study help from our Librarians.

Remember, the Library is here to support your university experience. Our goal is to help you succeed in your studies.

We look forward to seeing you in the Library!

Finding Study Resources

Whether you are on or off campus, the University Library website provides you with easy-to-use search tools and resources to aid your study and research.

www.murdoch.edu.au/library

Library Search

Look beyond Google! Library Search is the easiest way to find journal articles, books, ebooks and other online resources for your assignments.

Library Search is your direct path to peer-reviewed academic literature, which will give your work academic authority.

Head to the Library website to use Library Search.

My Unit Readings & High Demand

Go to 'My Unit Readings' to find essential and recommended readings set by your unit coordinators.

unitreadings.murdoch.edu.au

Reading lists are also accessible via My Murdoch.

The High Demand collection holds important print books and recommended readings identified by your unit coordinators for the current semester.

You can borrow these items for a short period or use them within the High Demand area.

Databases

Our databases are searchable online collections of resources which include journal articles, ebooks, streaming media and more.

Use databases when you want to search within a specific field or subject area. Databases also provide a faster route to specialised information such as law reports and legislation, company information and news.

goto.murdoch.edu.au/Databases

Print Collections

At the Geoffrey Bolton Library, the print collections are located in the south wing:

- Level 1: Journals 001-999
- Level 2: Books 500-999 and DVD collection
- Level 3: Books 340-349
- Level 4: Books 001-499 and Reference collection

Print items are also available at the Veterinary Library and Mandurah Campus Library.

Talk to Library staff if you require assistance locating an item from the collection.

Finding information and resources for assignments can be tricky! For best results, use the Library Search tool on the Library website.



Subject Guides

Subject Guides are a great starting point when researching a topic. These online guides provide subject-specific information and resources for your area of study. You will also find search tips and research strategies.

goto.murdoch.edu.au/SubjectGuides

Library Catalogue

The Library Catalogue is particularly good when searching for the exact title of the book or an author. Try the 'Keyword' search when looking for material on a particular topic.

goto.murdoch.edu.au/MurdochCatalogue

Past Exam Papers

The Library provides access to past exam papers that have been released in the last five years.

www.murdoch.edu.au/library/resources-collections/exam-papers

Can't find it at the Library?

If you are unable to find a book or resource from our collections, we can help to locate it for you from another library.

<https://www.murdoch.edu.au/library/borrow/borrowing-from-other-libraries>

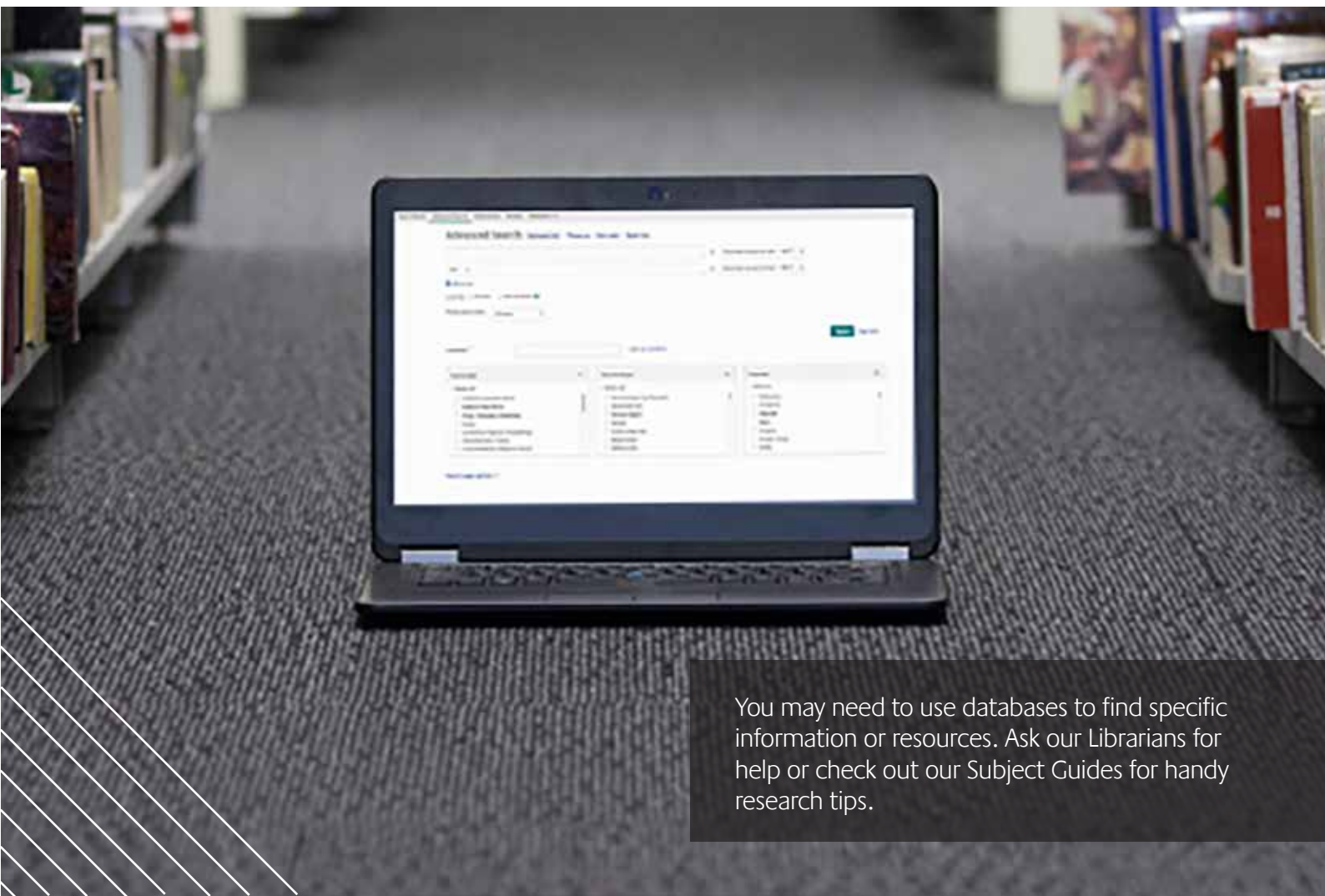

You may need to use databases to find specific information or resources. Ask our Librarians for help or check out our Subject Guides for handy research tips.

Borrowing



How to borrow

Use your student, staff or library card to borrow from the Library. We have self-check machines located at the Geoffrey Bolton Library and in the Veterinary Library, or take your items and card to the Help Desk.

Return your loans to any of our libraries, regardless of where you borrowed them. High Demand loans must be returned to the library where they were borrowed.

As an undergraduate student, you can borrow 30 items for 12 weeks. Keep in mind that borrowed items may be recalled if requested by someone else.

goto.murdoch.edu.au/Borrowing

Fines and charges

Ensure your borrowed items are returned by the due date to avoid fines. If you do not return an item on time, fines are added to your account - these are applied at different rates depending on the item.

If you have \$60 or more in fines, you will not be able to borrow items. You can keep track of and pay fines via My Library.

If you do not return your loans within four weeks of the due date, or you lose or damage an item, the Library will bill you for the cost of a replacement.

Renew your loans online

The easiest way to avoid fines is to renew your items online via My Library.

Log into My Library using your Murdoch University username and password.

You can renew items, check your borrowing history, and request items from the Library Catalogue.

mylibrary.murdoch.edu.au

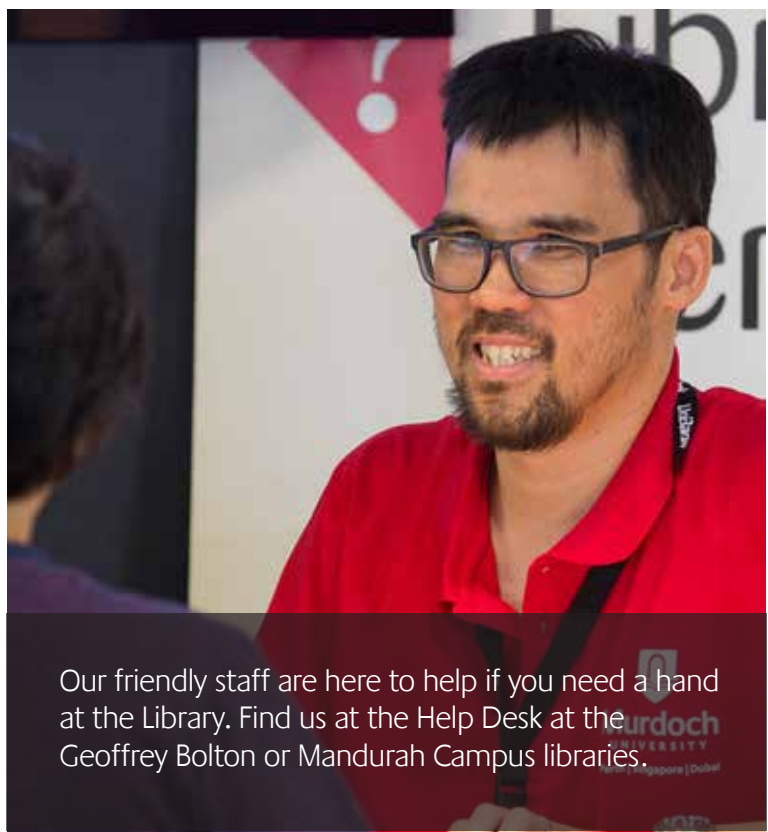

Our friendly staff are here to help if you need a hand at the Library. Find us at the Help Desk at the [Murdoch University](http://murdoch.edu.au) Geoffrey Bolton or Mandurah Campus libraries.

Study Spaces & Facilities

The University Library spans three locations across two campuses and offers a variety of study spaces and facilities that will suit your needs.

www.murdoch.edu.au/library/our-libraries/study-spaces

Buzz and Silent Study Zones

Like a bit of noise or working in groups? Choose the Buzz study zones. Prefer studying by yourself in peace and quiet? Then you'll love our silent study zones.

Look for the zone signs at the Geoffrey Bolton Library.

Book a study room

You can book a study room at the Geoffrey Bolton Library for group and collaborative work.

<http://libcal.murdoch.edu.au/>

Launchpad

Located on Level 3 of the Geoffrey Bolton Library, the Launchpad is a space for you to connect with innovative industry leaders and collaborate with like-minded students and entrepreneurs.

Study booths and desks in this area are bookable except when events are being held. Check the screens in the Launchpad for more information.

24-hour access

You can access the Geoffrey Bolton Library at any time using the Level 2 entrance near the ECL courtyard. Use your Murdoch ID card to swipe in.

After-hours access to the Veterinary Library is available to current Veterinary Science students and staff.



The Launchpad provides a dedicated space where you can connect with academics and engage with your business through real-world learning

BYO Device

You are welcome to use your own device at the Library. Our study areas have charging points for laptops and USB devices and you can connect to the Eduroam Wi-Fi network for Internet access anywhere on campus.

Use our computers

We have over 200 computers in the Library. You can log in to computers using your Murdoch username and password.

If you have trouble logging in, ask at the IT Service Desk.

www.murdoch.edu.au/library/our-libraries/computers-wifi

Printers are connected to all computers in the Library. Use your Murdoch ID card to pay for your printing and photocopying. You can add credit to your card online.

Geoffrey Bolton Library

LEVEL 1

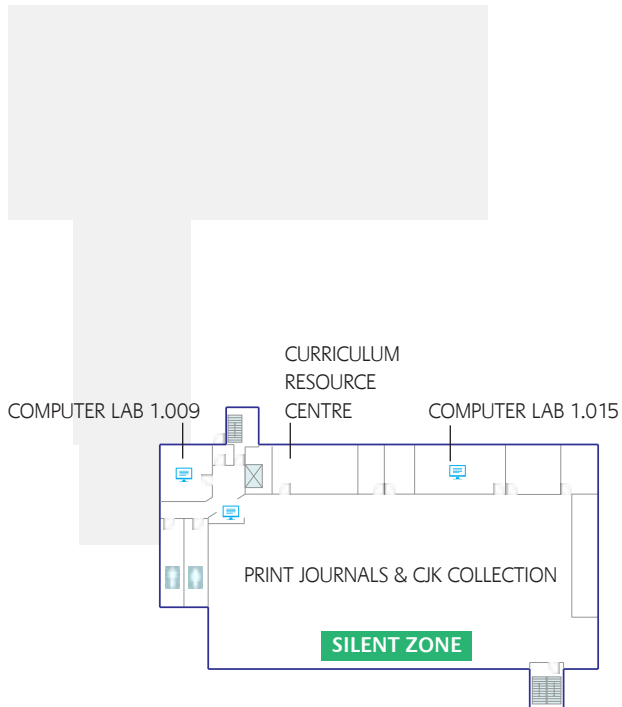

LEVEL 2

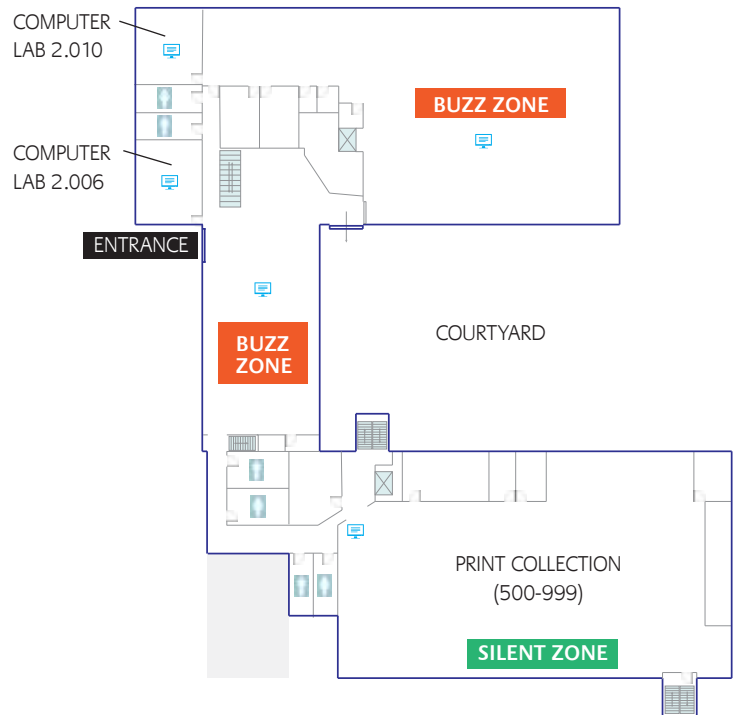

LEVEL 3

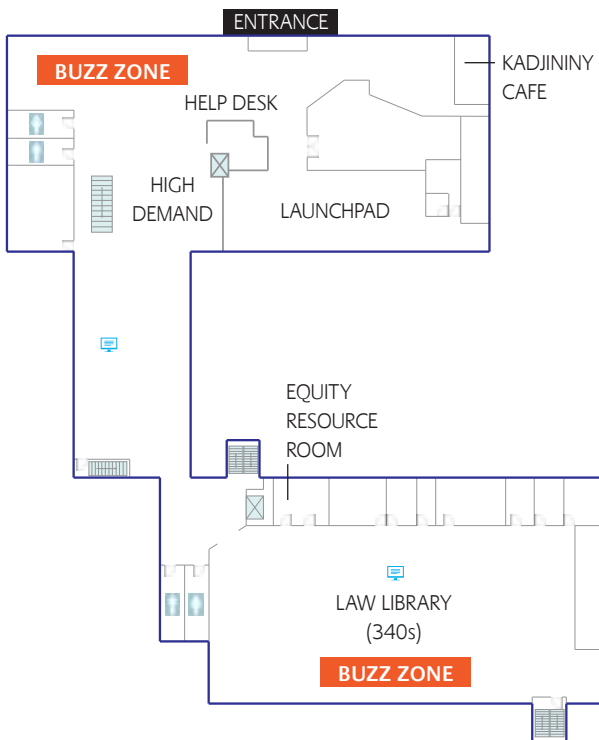

LEVEL 4

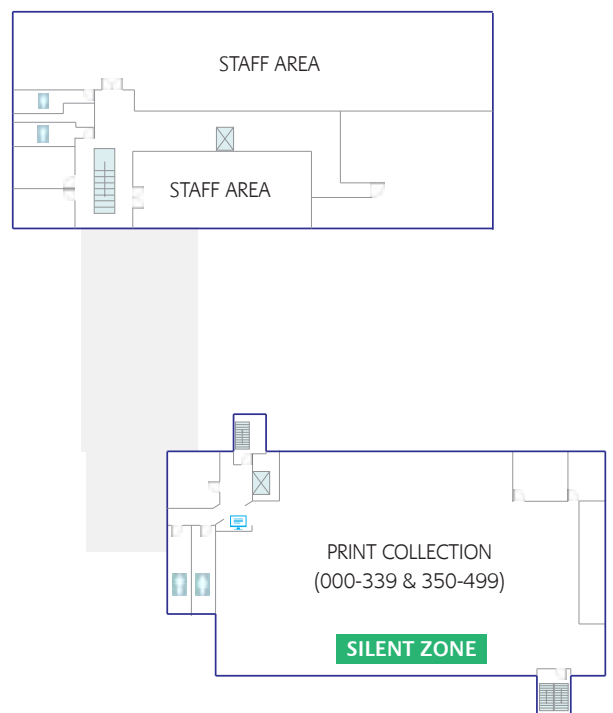

Veterinary Library

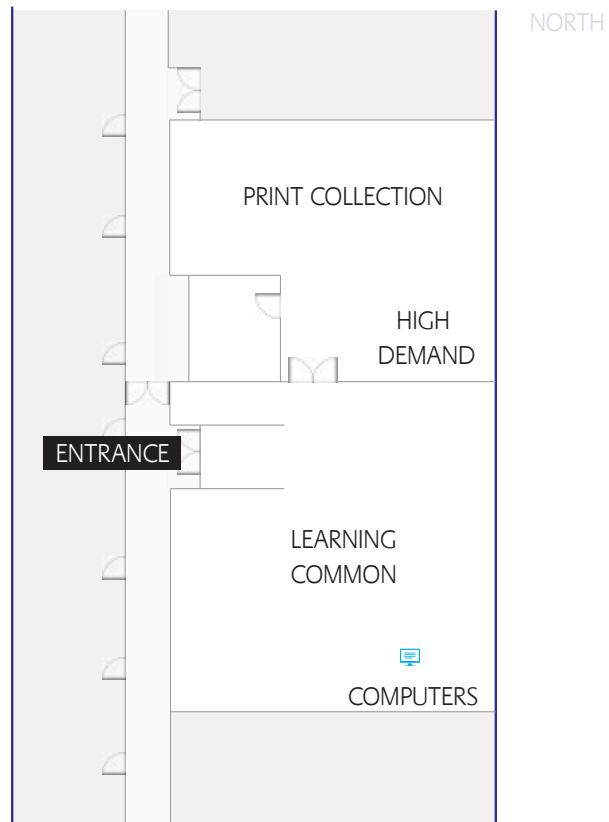

Mandurah Campus Library

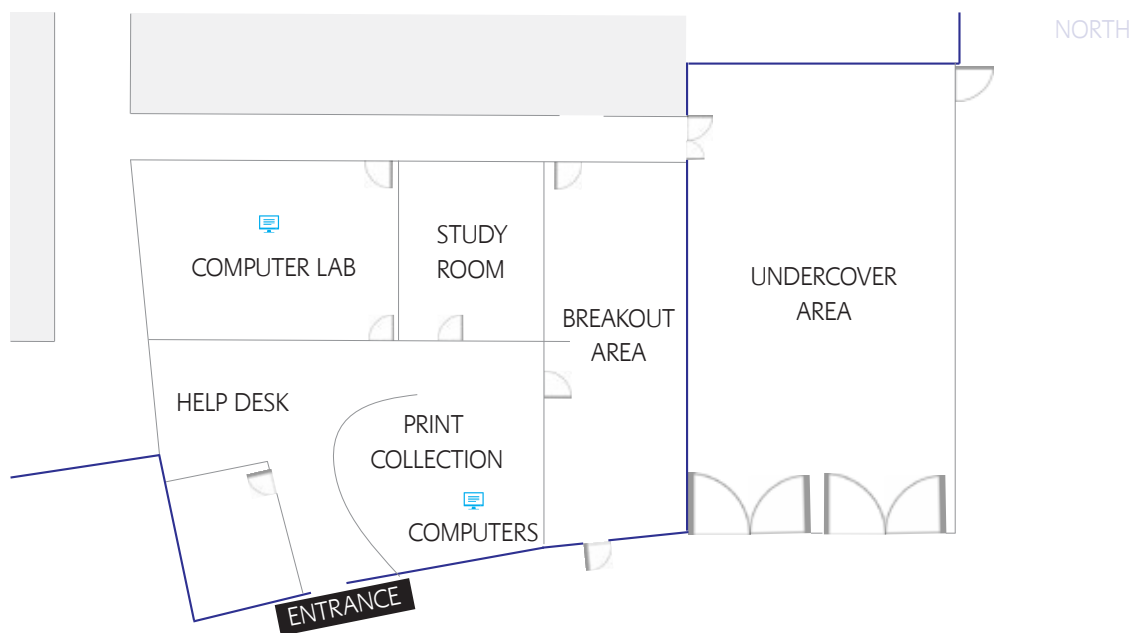

Help & Support

Tackling Your Assignments

There are better ways to research your assignment than by putting the whole question into Google! By using library resources, you will get direct access to millions of high-quality books, journal articles and other resources that you can use for your assignment.

Our Guide will step you through the processes you should take when searching for resources for your assignments including how to create your reference list.

www.murdoch.edu.au/library/help-support/support-for-students/assignment-help

Referencing Guides

By referencing your research correctly, you acknowledge the ideas of others and ensure the academic integrity of your own work. The Library website has up-to-date style guides for referencing styles used at Murdoch University. Check with your unit coordinator to find out which style you should use.

goto.murdoch.edu.au/Referencing

Off campus?

If you are studying off campus or overseas, you may be eligible for additional Library services.

www.murdoch.edu.au/library/help-support/support-for-students/off-campus-support

Ask Our Librarians

Need help finding resources for your assignments or building your research strategies?

Our Subject Librarians are skilled information professionals who can guide you through the process of researching for an assignment.

www.murdoch.edu.au/library/help-support/ask-our-librarians

Library Rovers

Need help finding a book on the shelves? Having trouble printing? Is it too noisy in the Silent zone? Our friendly Library Rovers can help!

You'll find them at the Geoffrey Bolton Library during teaching weeks. Alternatively, you can contact them via Facebook and they'll come to you!

IT Help

Computer trouble? Can't connect to WiFi? If you need support, see IT staff at the Geoffrey Bolton Library.

goto.murdoch.edu.au/ITServiceDesk

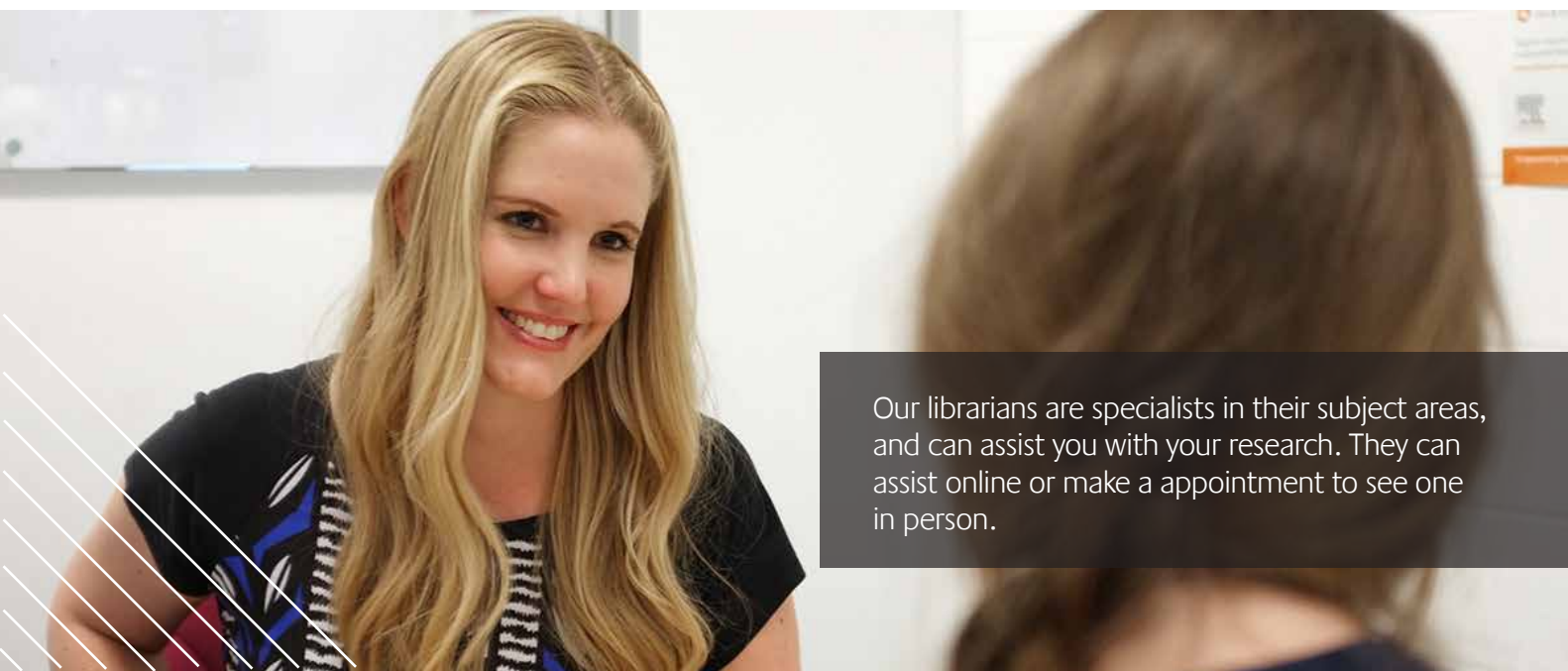

Our librarians are specialists in their subject areas, and can assist you with your research. They can assist online or make an appointment to see one in person.

Locations & Contact



Geoffrey Bolton Library

+61 8 9360 2563

Building 350
Perth Campus, 90 South Street
Murdoch WA 6150



Mandurah Campus Library

+61 8 9582 5521

Building 101 (Learning Common)
Mandurah Campus, Education Drive
Mandurah WA 6210



Veterinary Library

+61 8 9360 2563

Building 260, Room 2.10
Perth Campus, 90 South Street
Murdoch WA 6150

General Enquiries

To make contact with the Library, speak to Library staff at the Help Desk or submit your question online.

goto.murdoch.edu.au/SNLIBFM002

Feedback

Do you have any ideas that may improve our services or facilities? We welcome your feedback and consider all suggestions.

murdoch.edu.au/SNLIBFM018

Connect with us

Facebook: facebook.com/murdochlibrary

Twitter: twitter.com/murdochlibrary

Instagram: instagram.com/murdochlibrary

Disclaimer

The information contained within this publication was correct as of January 2019 and is subject to change without notice. Please visit the University Library website for the latest version of this publication: www.murdoch.edu.au/library

© 2019 Murdoch University



Murdoch
UNIVERSITY